



Web:yumisteel.com;
yumisteelmaterial.com



Tel: +86-592-6095031
Mob: +86-13559086380



admin@yumisteel.com;
customerservice@yumisteel.com.

CONTAINER HOUSE FOR LIVING



Content

- 01 Container house introduction
- 02 Models for choices
- 03 Decoration material for choices
- 04 Project



Container house introduction-flat packed type

剖面图

Section pic

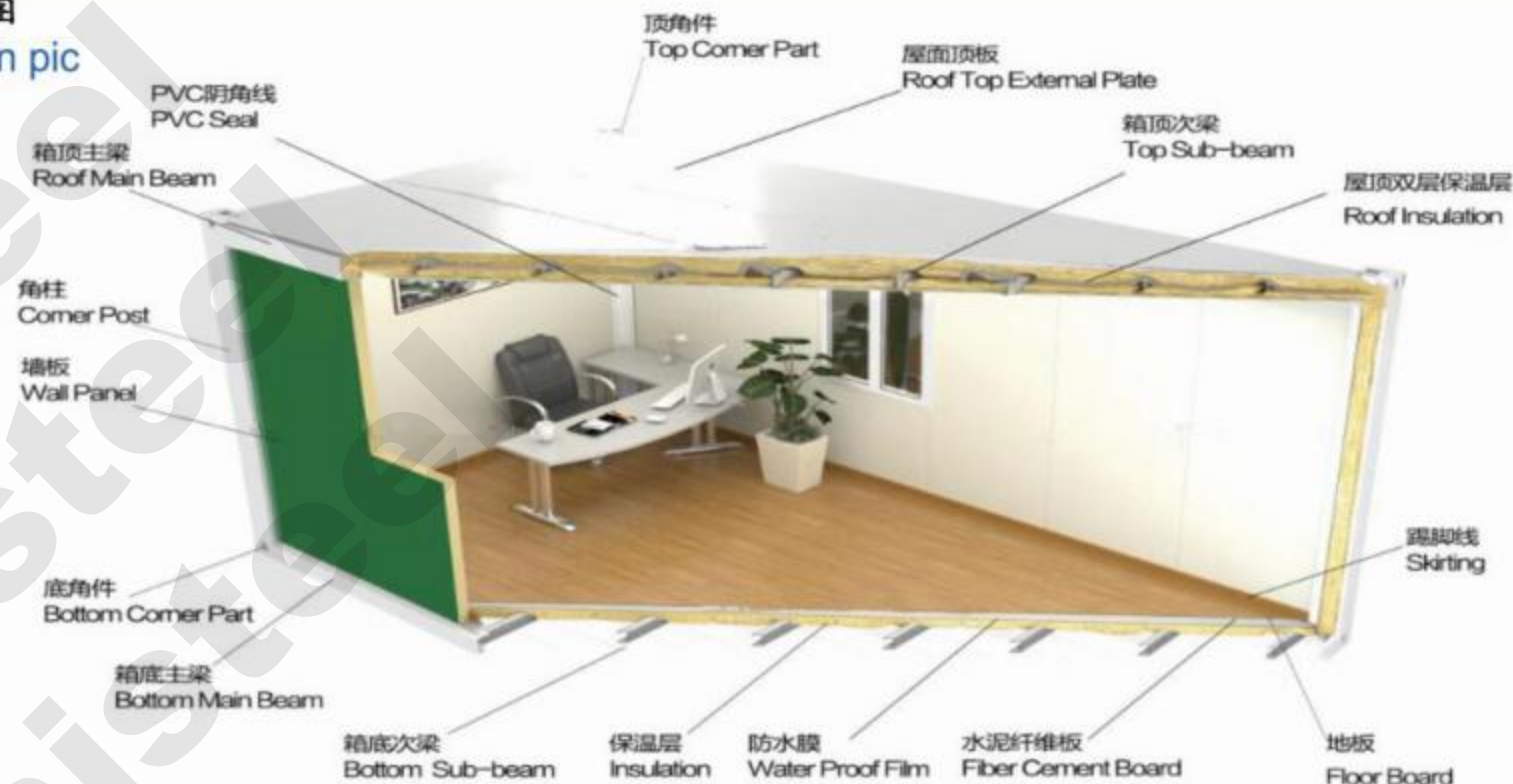

Fashion&Fast

Flat-packed Modular House matches ISO dimensions and have the advantages of international transport. The construction is based on a stable frame and interchangeable wall panels. The individual modular houses can be stood side-by-side in longitudinal and transverse direction without limits. It also can be stacked to 3 stories height on top of each other. Individual sizes of space can be achieved by removing outer wall panels and fitting partitions. The flat-packed modular houses can be delivered assembled or individually — in packages 647mm high. The storeys of flat packed container house can't be over 3.

Container house introduction-quick assembled type

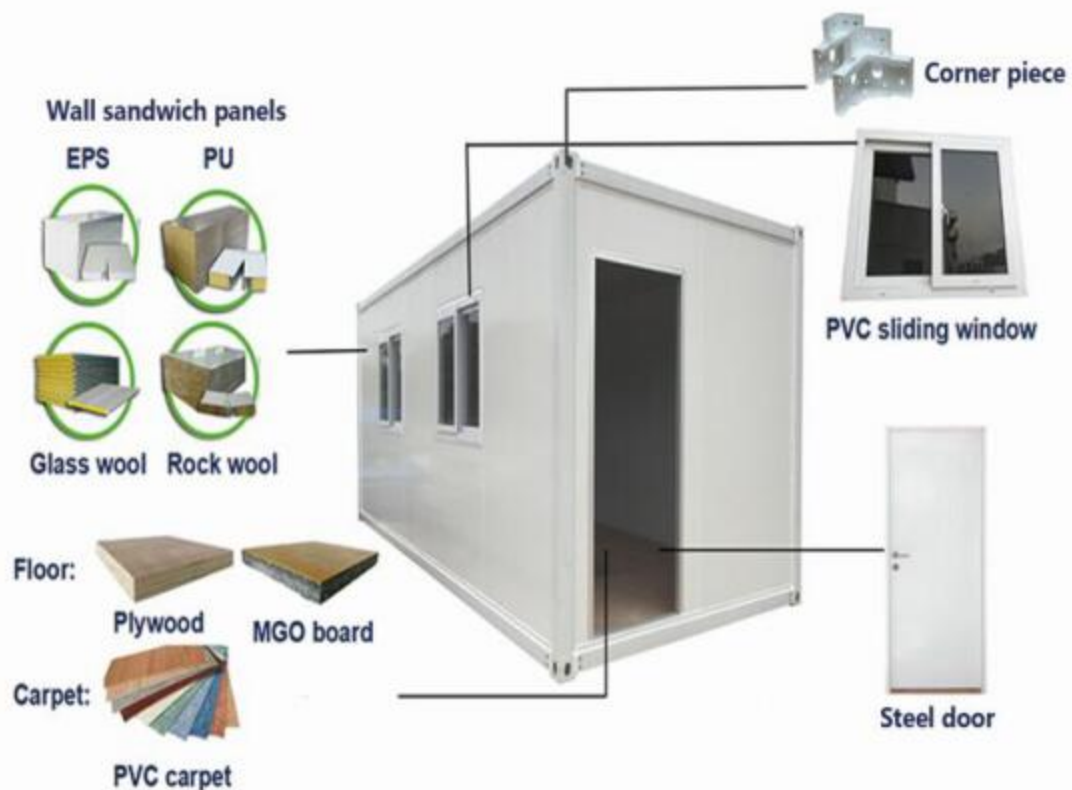

What' s quick assembled type?

Compared to flat packed type, the roof and floor part are already made in our workshop, all the material of quick assembled type are scattered, this requires customer to install all the part at site. The advantage is the cost is more competitive than flat packed type.

Size of container house for choice:

Size	External Dimensions			Internal Dimensions			Weight
	Length	Width	Height	Length	Width	Height	
8'X8'	2435mm	2435mm	2896mm	2235mm	2235mm	2625mm	950kg
10'X8'	3025mm	2435mm	2896mm	2825mm	2235mm	2625mm	1150kg
16'X8'	4885mm	2435mm	2896mm	4685mm	2235mm	2625mm	1350kg
20'X8'	6055mm	2435mm	2896mm	5855mm	2235mm	2625mm	1800kg
Standard							
24'X8'	7200mm	2435mm	2896mm	7000mm	2235mm	2625mm	2300kg
30'X8'	9000mm	2435mm	2896mm	8800mm	2235mm	2625mm	2450kg
20'X10'	6055mm	3000mm	2896mm	5855mm	2800mm	2625mm	2380kg

Remark: Also available external height of 3300mm. Individual packing height: 648mm.

Models for choices



Model NO.:YMCTN01-01

Common white grey colors, without any decoration for external wall.



Model NO.:YMCTN01-02

Sandwich panels with wood grain for external wall decoration.



Model NO.:YMCTN01-03

Add one more thin layer of PU insulated panels for external wall decoration.



Internal configuration

This model is including 2 bedrooms+1 bathroom+1 kitchen+1 dinning room+1 living room. Total area:44.29m²



Model NO.:YMCTN02-01

Common white grey colors, without any decoration for external wall.



Model NO.:YMCTN02-02

Sandwich panels with wood grain for external wall decoration.



Model NO.:YMCTN02-03

Add one more thin layer of PU insulated panels for external wall decoration.



Internal configuration

This model is including 2 bedrooms+1 bathroom+1 kitchen+1 dinning room+1 living room+1 balcony. Total area:53.29m²

Model NO.:YMCTN03



Model NO.:YMCTN04



This model is including
3 bedrooms
2 bathrooms
2 kitchens
2 dining rooms
2 living rooms
1 balcony.
Ground floor:59.05m²
First floor:59.05m²

Model NO.:YMCTN05



Ground floor



First floor

This model is including 2 bedrooms+2
bathrooms +1 kitchen+1 dining room+1
living room+1 balcony.
Ground floor:29.52m²
First floor:29.52m²

Model NO.:YMCTN06



This is including 2 bedrooms,1 bathroom,
1 kitchen,1 dining room and 1 balcony.
Total area:44.29m²



Model NO.:YMCTN07

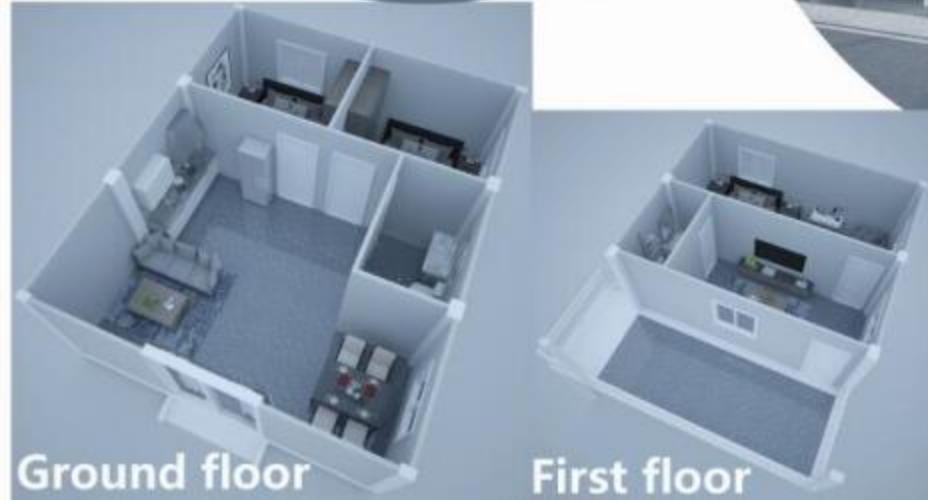

This model is including 3 bedrooms+2 bathrooms +1 kitchen+1 dinning room+2 living rooms+1 balcony.
 Ground floor:44.29m²
 First floor:44.29m²

Model NO.:YMCTN08



This model is including 4 bedrooms+2 bathrooms +1 kitchen+1 dinning room+1 balcony.
 Ground floor:66.25m²
 First floor:44.29m²



Model NO.:YMCTN09

11



This model is including 2 bedrooms+2 bathrooms +1 kitchen+1 dinning room+1 living rooms+1 balcony.

Total area:61.55m²

Ground floor

1st floor

Model NO.:YMCTN10

12



Floor plan per unit

This model is an apartment design.

One unit:2 bedrooms+2 bathrooms+1 kithchen+1 dinning room+1 living room.

Total: 4 units, 64.9m²/unit

Ground floor: 159.19

First floor area:159.19m²



This model is an apartment design.

One unit:1 bedrooms+1 bathroom+
1 kithchen+1 dinning room+1 living
room+1 study.

Total: 8 units, 50.14m²/unit

Ground floor:211.21m²

First floor area:208.21m²

Models for choices

Model NO.:YMCTN12



Model NO.:YMCTN13



Model NO.:YMCTN14



Ground floor

First floor

Models for choices

Floor plan for YMCTN14

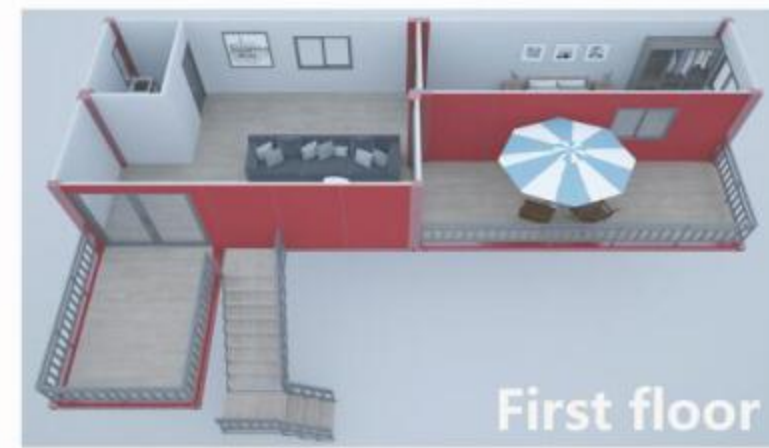

Model NO.:YMCTN15

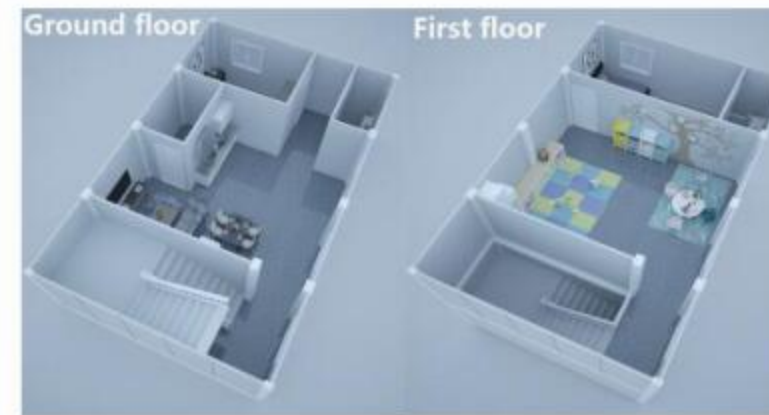

Decoration material for choices

Internal decorative fiberboard



Bamboo-wood fiber integrated wallboard adopts foreign imported polymer nanotechnology, original ecological bamboo fiber, polymer waterproof and fireproof material, spar powder high temperature pressing, and the surface adopts high-end fashion decorative film high-temperature laminating or rolling coating technology, very environmentally friendly and fashionable. The surface treatment is all made of environmentally friendly materials, without paint components, the decorated room has no peculiar smell, and there is no harmful ingredient to the human body, completely bid farewell to formaldehyde, and truly achieve zero carbon and zero emissions. It is a new type of integrated wall panel, which is made of bamboo, wood fiber, polymer waterproof and fireproof material, and spar powder at high temperature. It has heat preservation, sound insulation, heat insulation, moisture resistance, fire resistance, easy installation, easy modeling, and high resistance to hanging and rubbing. An integrated wall decoration material with many elements such as high green environmental protection, 4D art and fashion.

**Various colors for choices,
Environmental protection~**



Ground floor

1st floor

Decoration material for choices

PU metal panels for external decoration

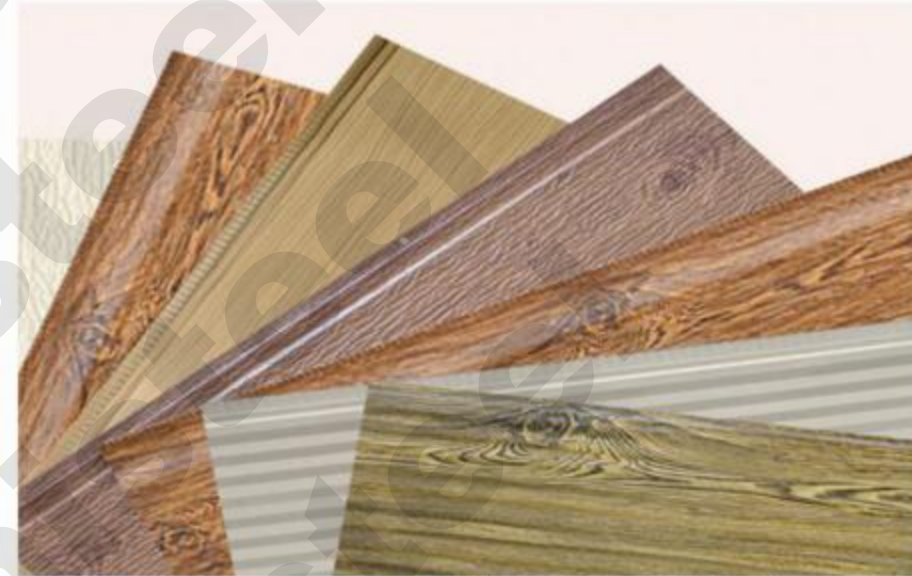

PU insulated metal panels provide unique aesthetics through a wide range of profiles while delivering excellent thermal performance. Our panels are built to your specifications, ensuring they are perfect for your needs. We only use the highest quality materials, long life automotive grade rust-proof paint, producing superior products that are durable.

Exterior of insulated panels mainly consists of: Al-Zn alloy coated steel sheet (55% aluminum) treated with special fabrication processing on the surface, high density polyurethane (PU/PUR) as core and aluminum paper or steel sheet. The endurance quality of Al-Zn alloy coated steel sheet with 55% aluminum is 3-6 times higher than that of galvanized steel sheet and aluminum steel sheet (recognized by the World Steel Association). Our Insulated metal panels are available in thicknesses 16mm, 25mm and 50mm.

**High R-Value,
Energy efficient!**

Decoration material for choices

Wall claddings for external decoration



Corrugated metal roof is using color coated steel or aluminum alloy metal sheets and cold-rolled into various profiled sheets by rolling equipment. Corrugated metal roof or steel sheets are an energy-efficient, low cost, and long-lasting roofing and wall cladding option for homes, log cabins, and commercial building envelope applications.



Ground floor

2nd floor

Project



Country: China

Container house for living inside a factory

Project

Wall claddings for external decoration



Country:Slovakia

Container house for staff dormitory



Country:Cyprus

Container house for single room

Ground floor

1st floor

Project



Country:Chile

Container house for living



Country:Philippines

Container house for living